

This document is the property of Connector Corporation and is delivered on the express condition that it is not to be disclosed, reproduced or used, in whole or in part, for manufacture or sale by anyone other than Connector Corporation without its prior consent and that no right is granted to disclose or to use any information in this document.

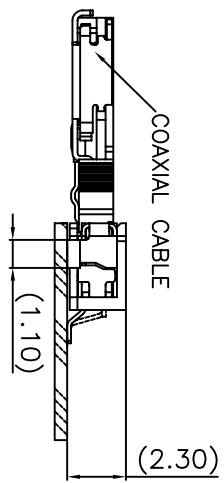

MATED CONDITION(REF)

CONTROLLED DOCUMENT

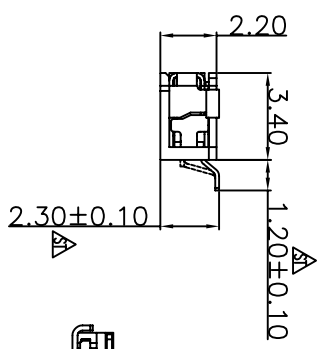
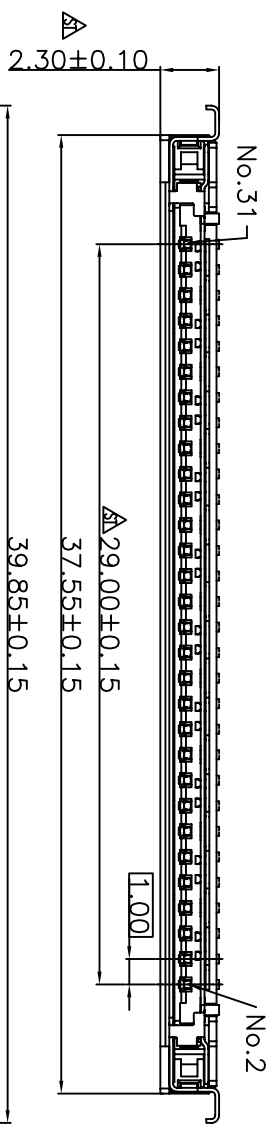
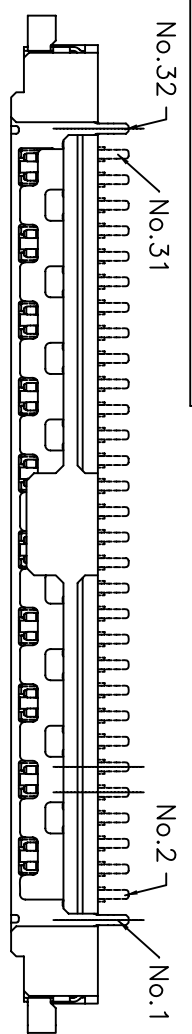

SYM	ECN NO.	DESCRIPTION	DATE	APP'D
A	ECON08022	FOR 2008 ROHS	02/21/08	JEFF HSIEH
B	ECON08085	CHANGE SEE Δ	11/17/08	JEFF HSIEH



SOLDER AREA $\square 0.10$

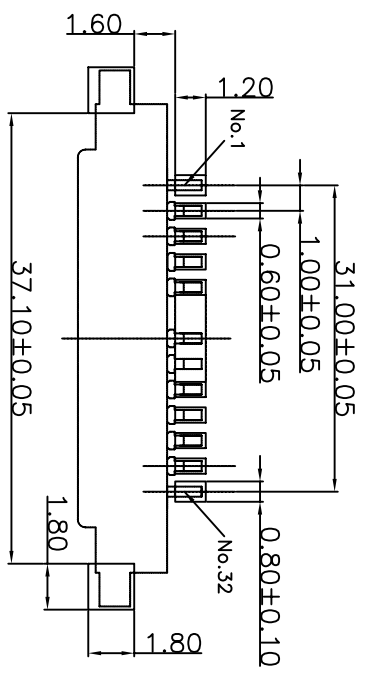

APPLICABLE PCB DIMENSION(REF)

NOTES:

1. MATERIAL: INSULATOR: LCP UL94V-0
CONTACT: PHOSPHOR BRONZE
SHELL: Cu-Ni-Zn ALLOY
2. CONTACT FINISH: 1. 5u" MIN. GOLD ON CONTACT. TIN ON SOLDER TAIL. BOTH OVER NICKEL.(LEADFREE MATTE)
2. 15u" MIN. GOLD ON CONTACT. TIN ON SOLDER TAIL. BOTH OVER NICKEL.(LEADFREE MATTE)
3. IMPORTANT AREA FLASH: 0.05mm MAX. DAMAGE: NA. DEFORM: NA.
4. LOGO TYPE: 2.WITHOUT LOGO
5. PACKING TYPE: 1.REEL 2. TRAY 3.TUBE
6. INSPECTING POINT
7. ORDERING CODE: CNT H 243A XX X X X

FOR 2008 ROHS

PACKING TYPE SEE NOTES 5
LOGO TYPE SEE NOTES 4
CONTACT FINISH SEE NOTES 2
CKT NO. 30

TOLERANCE	
X.	±0.35
X.X	±0.25
X.XX	±0.15
X.XXX	±0.05
ANGULA	±3°

UNLESS OTHERWISE SPECIFIED

APPROVALS	
DRAWN	William Wu
CHK'D	Jesse Mo
APP'D	Jeff Hsieh

DATE	SIZE:
11/17/08	A4
11/26/08	

PART NO.	DRAWING NO.	SHEET
CNTH243AXXXXXX	P008-CNTH243AXXXXXX-C	1 OF 3

CONNECTER
Precision Enterprise Co., Ltd

TITLE:
LCD CONN., RECEPTACLE, PH=1.0mm
SMT., RIGHT ANGLE, ON-BOARD TYPE
MECHANICAL LOCK, PCB MOUNTED
HEIGHT=2.3mm

REV. B

This document is the property of Connector Corporation and is delivered on the express condition that it is not to be disclosed, reproduced or used, in whole or in part, for manufacture or sale by anyone other than Connector Corporation without its prior consent and that no right is granted to disclose or to use any information in this document.

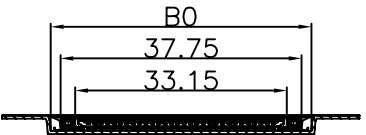
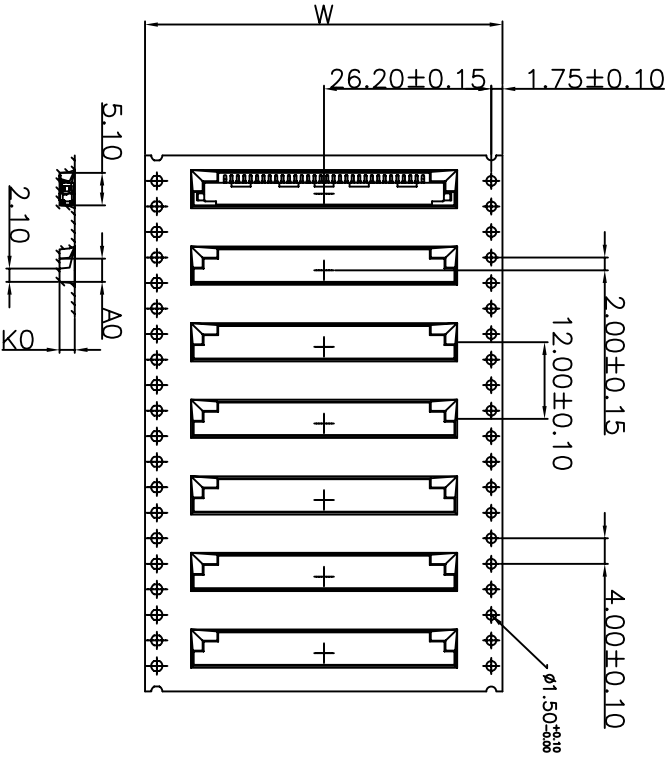
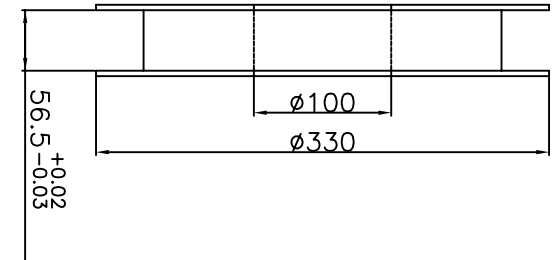
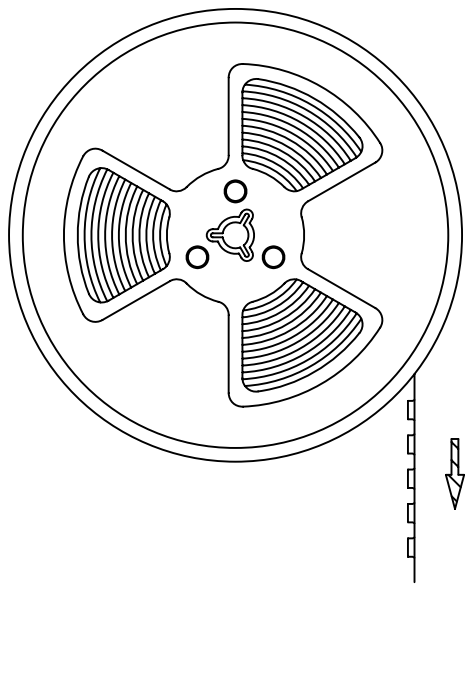

SYM	ECN NO.	DESCRIPTION	DATE	APP'D
A	ECON08022	FOR 2008 ROHS	02/21/08	JEFF HSIEH
B	ECON08085	CHANGE SEE Δ	11/17/08	JEFF HSIEH

1. 10 sprocket hole pitch cumulative tolerance ± 0.20 .
2. Carrier camber is within 1 mm in 250 mm.
3. Material : Black Conductive Polystyrene Alloy
4. All dimensions meet EIA-481-C requirements.
5. Thickness : 0.30 ± 0.05 mm.
6. Component load per 13" reel : 2000 pcs.



Patent No. 157713

W	56.00 \pm 0.30
A0	3.65 \pm 0.10
B0	40.85 \pm 0.10
K0	2.50 \pm 0.10

TOLERANCE	APPROVALS	DATE	PART NO.	TITLE:
X. ± 0.35	DRWN William Wu	11/17/08	CNTH243AXXXXXX	LCD CONN., RECEPTACLE, PH=1.0mm
X.X ± 0.25	CHK'D Jesse Mo	11/17/08	DRAWING NO. P008-CNTH243AXXXXXX-C	SMT., RIGHT ANGLE, ON-BOARD TYPE
X.XX ± 0.15	APP'D Jeff Hsieh	11/26/08		MECHANICAL LOCK, PCB MOUNTED
X.XXX ± 0.05				HEIGHT=2.3mm
ANGULA $\pm 3^\circ$				

UNLESS OTHERWISE SPECIFIED



REV. B

This document is the property of Connector Corporation and is delivered on the express condition that it is not to be disclosed, reproduced, used, in whole or in part, for manufacture or sale by anyone other than Connector Corporation without its prior consent and that no right is granted to disclose or to use any information in this document.

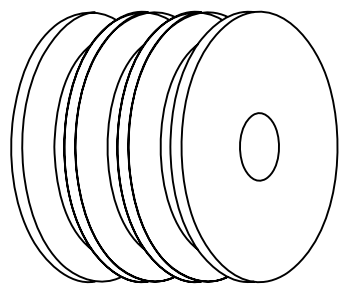

4RE/BC

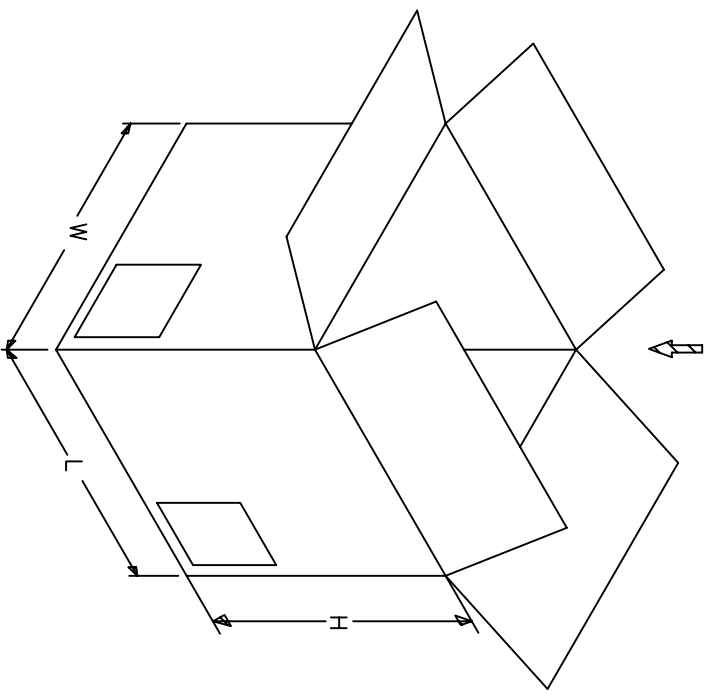

SYM	ECN NO.	DESCRIPTION	DATE	APP'D
A	ECON08022	FOR 2008 ROHS	02/21/08	JEFF HSIEH
B	ECON08085	CHANGE SEE A	11/17/08	JEFF HSIEH

PACKING MATERIAL

PART NAME	DIM(mm)
REEL	330X56.5
BIG CARTON	350X350X340

PACKING CAPACITY

PART NO.	PCS/RE	RE/BC	PCS/BC
CNTH243A30XXX	2000PCS/RE	4 RE/BC	8000 PCS/BC



TOLERANCE

X.	±0.35
X.X	±0.25
X.XX	±0.15
X.XXX	±0.05
ANGULA	±3°

UNLESS OTHERWISE SPECIFIED

APPROVALS	DATE
DRAWN William Wu	11/17/08
CHK'D Jesse Mo	11/17/08
APP'D Jeff Hsieh	11/26/08
UNITS:mm	SCALE:1:1
SIZE: A4	

CONNECTER
Precision Enterprise Co., Ltd

PART NO.	CNTH243AXXXXXX
DRAWING NO.	P008-CNTH243AXXXXX-C
TITLE:	LCD CONN., RECEPTACLE, PH=1.0mm SMT., RIGHT ANGLE, ON-BOARD TYPE MECHANICAL LOCK, PCB MOUNTED HEIGHT=2.3mm
REV. B	